

PVR1 SERIES VANE PUMPS

VARIABLE DISPLACEMENT PRESSURE COMPENSATED



Manifold Mounted

OVERALL EFFICIENCY

1750 rpm at Full Displacement

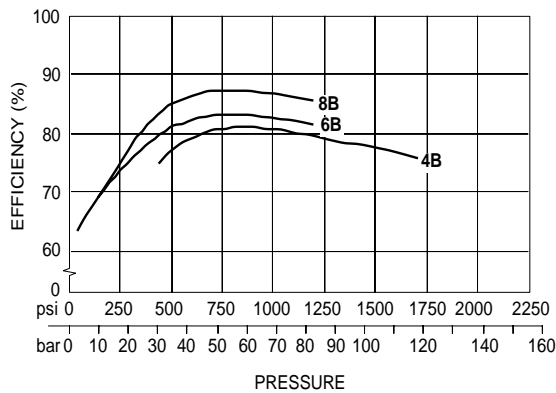

TYPICAL SOUND LEVEL @ 1750 rpm

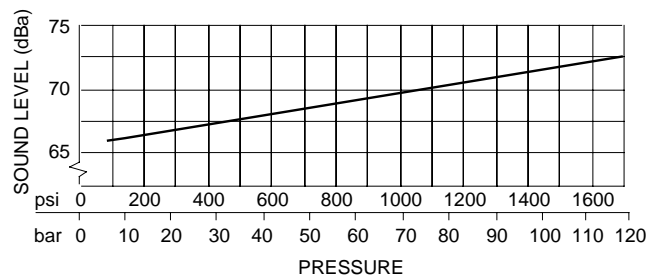

TYPICAL PERFORMANCE SPECIFICATIONS

		PUMP SIZE				
		4B	6B	8B		
VOLUMETRIC DISPLACEMENT*	cu. in./rev.	0.7	0.9	1.2		
	ml/rev.	11.5	14.8	19.7		
PUMP DELIVERY AT 1750 RPM*	91.5 psi	gpm	5	7	9.5	
	6.3 bar	lpm	19	26.5	36	
	rated	gpm	4	6	8	
	pressure	lpm	15.1	22.8	30.5	
COMPENSATED PRESSURE RANGES	Max.	psi	1500	1000	1000	
		bar	103	69	69	
	Rated	psi	1500	1000	1000	
		bar	103	69	69	
	Min.	psi	400	100	100	
		bar	28	7	7	
OPERATING SPEEDS**	Min. rpm	800				
	Rated rpm	1750				
	Max. rpm	3600				
POWER INPUT AT RATED (1750 rpm) FLOW & PRESSURE	hp	5	5	6		
	kW	3.7	3.7	4.4		
SUCTION	PRESSURE	Max.	psi	10		
			bar	0.7		
		Min.	in./Hg	7		
	Specific Gravity < 1	Min.	bar	-0.25		
			in./Hg	5		
	Specific Gravity > 1	Min.	bar	-0.17		
FLUID VELOCITY	Max.	ft./sec.	5			
		m/sec.	1.5			
CASE CRAN	NOMINAL FLOW AT DEADHEAD PRESSURE	Max.	cipm	65	36	55
			mlpm	1065	600	900
	PRESSURE	Min.	cipm	25	10	24
			mlpm	410	170	390
MAXIMUM CASE PRESSURE		psi	10			
		bar	0.7			
WEIGHT		lbs.	20			
		kg	9			

NOTES:

* Volumetric displacement is measured displacement at 91.5 psi (6.3 bar) and rated rpm. Volumetric displacement varies with both pressure and rpm. Flow rates at any rpm other than the rated rpm may be approximated as follows:

$$Q_2 = Q_1 (N-142)/1667 \text{ where } Q_1 = \text{Flow (gpm) at rated rpm at 91.5 psi (6.3 bar).}$$

$$Q_2 = \text{Flow (gpm) at } N \text{ rpm.}$$

$$N = \text{rpm at which } Q_2 \text{ is to be determined.}$$

** **6B** - Maximum rpm at full displacement - 2800 rpm. For higher rpms up to 3600 rpm, pump displacement must be reduced to limit flow to 9.5 gpm (36 lpm) maximum.

8B - Maximum rpm at full displacement - 2100 rpm. For higher rpms up to 3600 rpm, pump displacement must be reduced to limit flow to 9.5 gpm (36 lpm) maximum.

PRESSURE and VOLUME ADJUSTMENT SENSITIVITY

		PUMP SIZE			4B			6B			8B		
		PRESSURE CODE			10	15	03	06	10	03	06	10	
PRESSURE ADJUSTMENT	Press Change/Turn	psi (bar)	255 (17.8)	270 (18.6)	115 (7.9)	210 (14.5)	240 (16.5)	115 (7.9)	210 (14.5)	240 (16.6)			
	Max. Torque	ft./lbs. (kg/m)	4.0 (0.55)	6.0 (0.83)	1.4 (0.19)	2.6 (0.36)	4.0 (0.55)	1.4 (0.19)	2.6 (0.36)	4.0 (0.55)			
VOLUME ADJUSTMENT	Flow Change/Turn	gpm (lpm)	3.4 (12.5)			4.6 (17.4)			4.6 (17.4)				
	Min. Flow Adjust.	gpm (lpm)	1.25 (4.7)			1.25 (4.7)			1.25 (4.7)				
	Max. Torque	ft./lbs. (kg/m)	2.5 (0.34)			1.0 (0.14)			1.0 (0.14)				

CAUTION: Turning the Maximum Volume Control in too far can force the cam ring over-center, causing damage.



PVR1 SERIES VANE PUMPS

VARIABLE DISPLACEMENT PRESSURE COMPENSATED

NOTE: Typical performance curves are based on ISO VG46 oil at 120° F. (49° C.). Above 400 SUS (84 CS), add 2% hp/100 SUS.

NOTE: Deadhead horsepower is read from curves at 0 gpm flow and pressure compensator setting psi.

4B10 (at 1750 rpm)

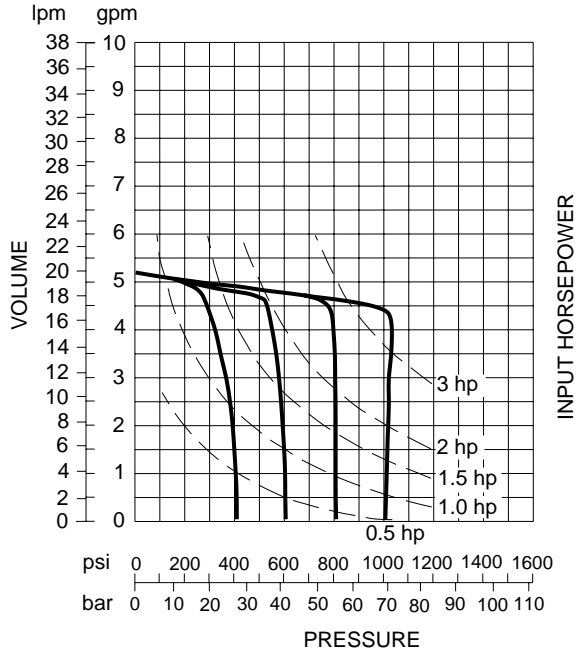

4B15 (at 1750 rpm)

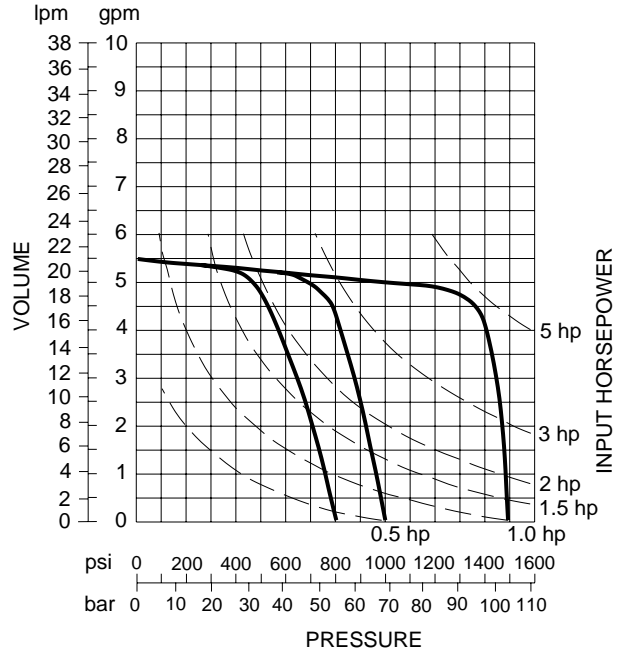

6B03 (at 1750 rpm)

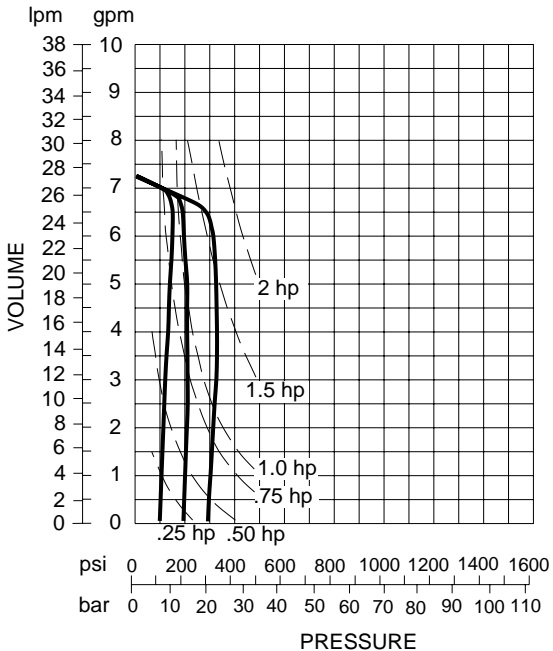

6B06 (at 1750 rpm)

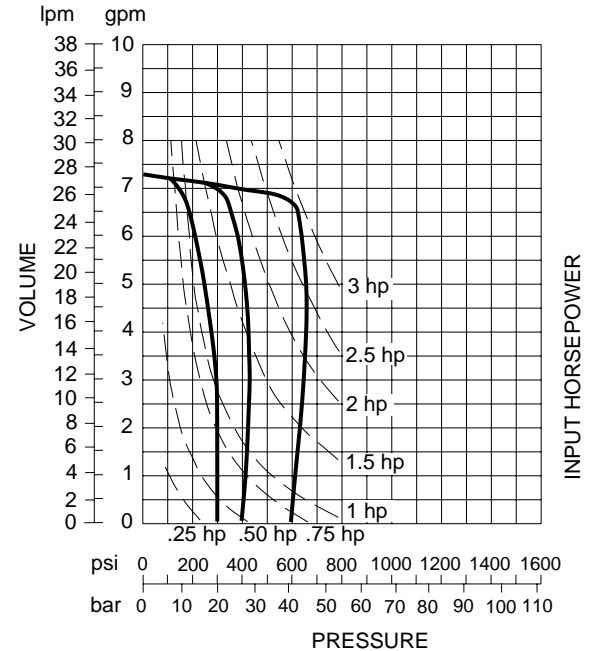

PVR1 SERIES VANE PUMPS

VARIABLE DISPLACEMENT PRESSURE COMPENSATED



NOTE: Typical performance curves are based on ISO VG46 oil at 120° F. (49° C.). Above 400 SUS (84 CS), add 2% hp/100 SUS.

NOTE: Deadhead horsepower is read from curves at 0 gpm flow and pressure compensator setting psi.

6B10 (at 1750 rpm)

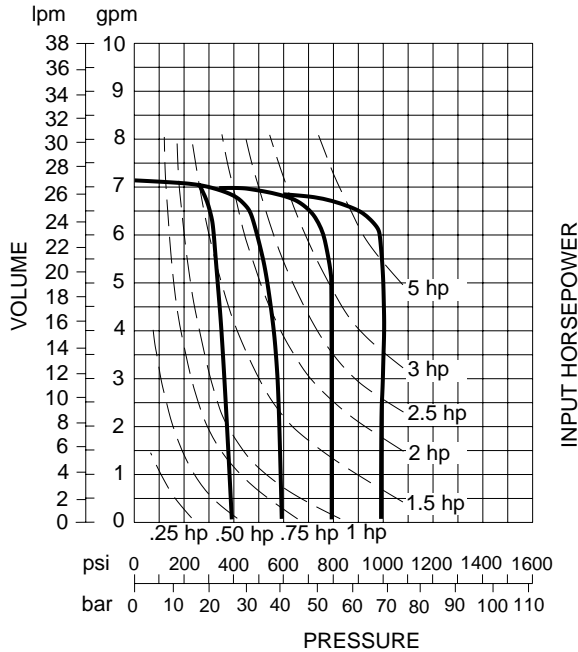

8B03 (at 1750 rpm)

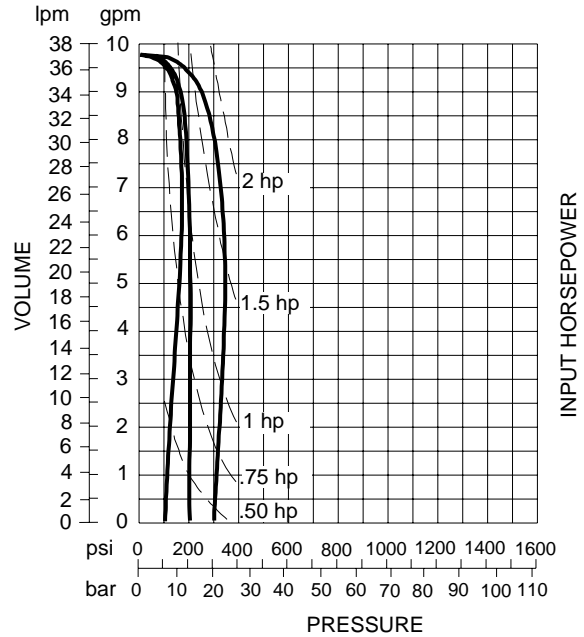

8B06 (at 1750 rpm)

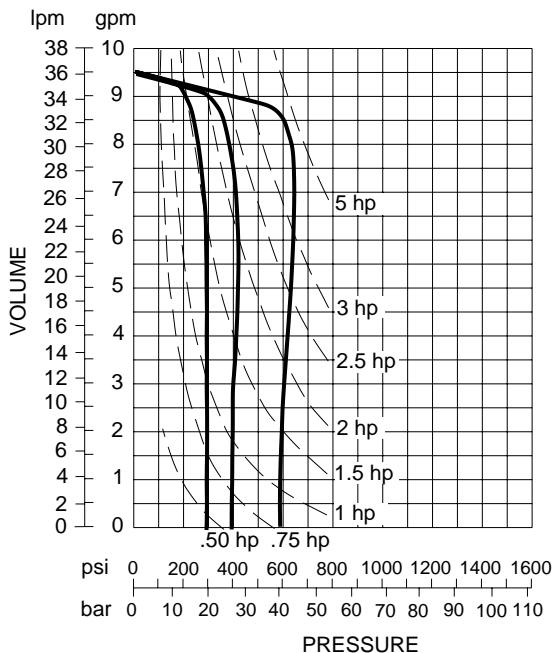

8B10 (at 1750 rpm)

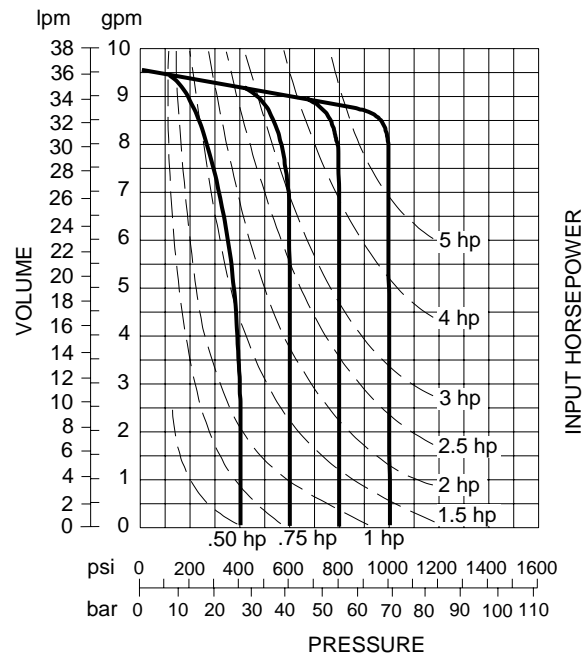



PVR1 SERIES VANE PUMPS

VARIABLE DISPLACEMENT PRESSURE COMPENSATED

PUMP DIMENSIONS

Dimensions shown in: Inches
(millimeters)

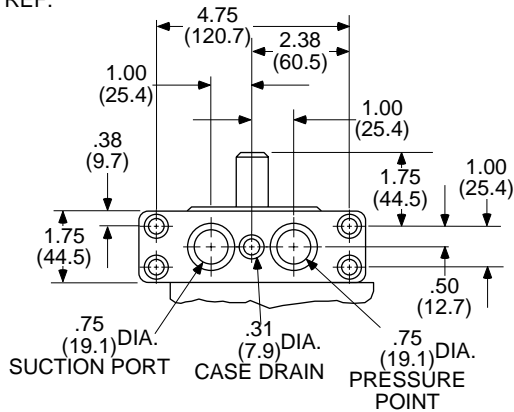
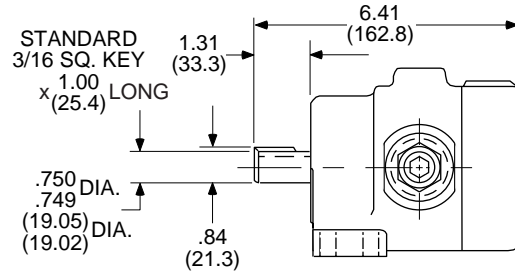
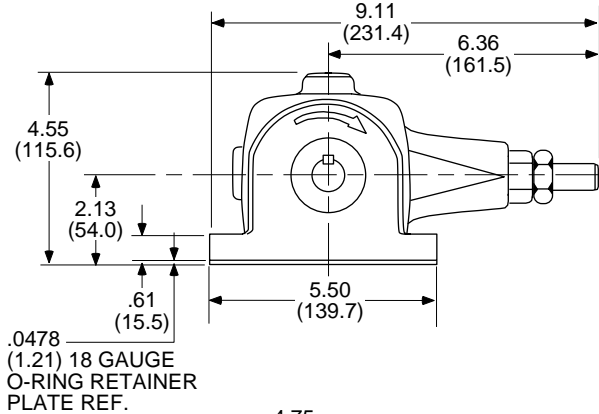

MECHANICAL OPTIONS

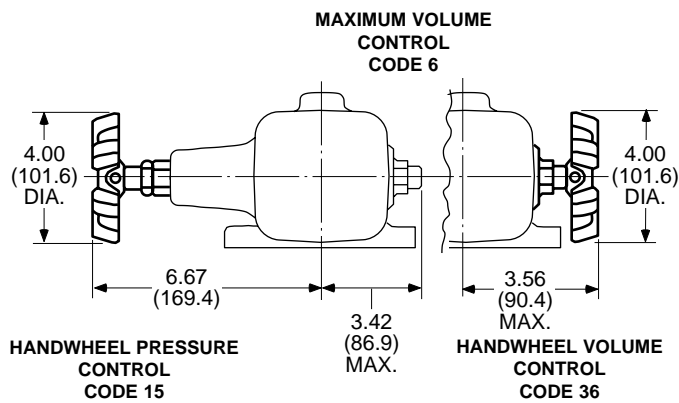

SIDE LOAD DRIVES

i.e. Belt, Chain, Gear

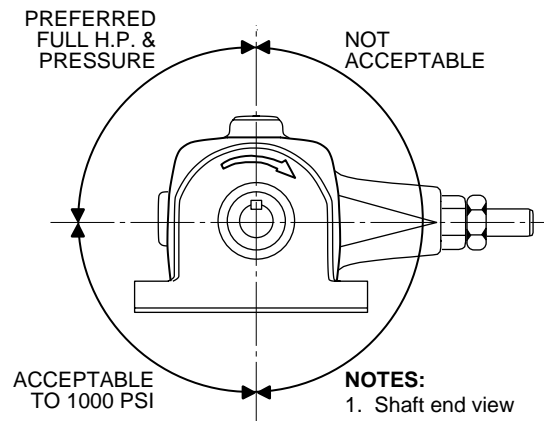

NOTES:

1. Shaft end view
2. 1750 rpm rated
3. Capable of full pump horsepower (load to radiate out from shaft)

PVR1 SERIES VANE PUMPS

VARIABLE DISPLACEMENT PRESSURE COMPENSATED



ORDERING INFORMATION

Right Hand (CW) Rotation

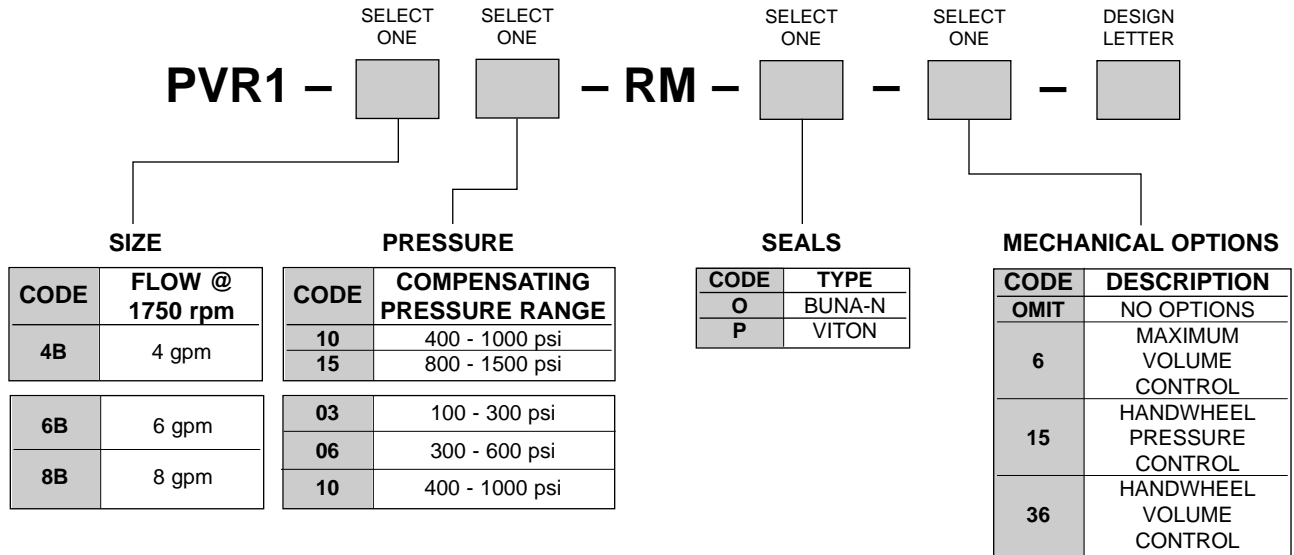

TYPICAL ORDERING CODE:
PVR1-6B10-RM-0-1-I

For more information please contact:



2 Swallow Drive, Alsager, Stoke on Trent, Staffs, ST7 2GJ

You can telephone or fax us in the UK on:

Tel: 08450 043440

Fax: 01270 876281



Web: <http://www.continentalhydraulics.co.uk>